

# THREE SIDED FIRE DOOR FRAMES

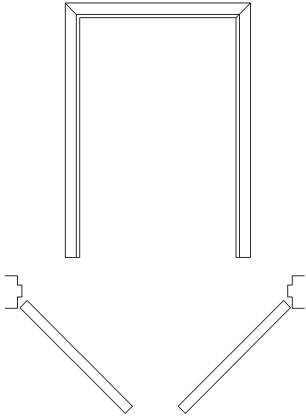

Pair of Doors  
(No Mullion)

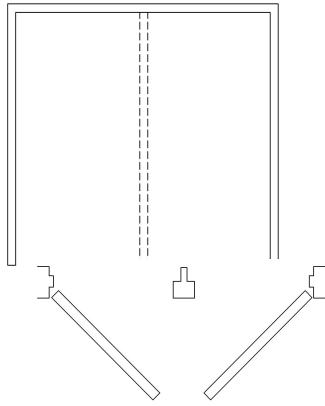

Pair of Doors  
Welded or Removable  
Mullion Behind Doors

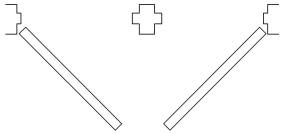

2 Singles  
Welded or Removable  
Mullion Between Doors

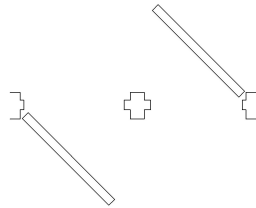

2 Singles  
Welded or Removable Contra-  
Swing Mullion Between Doors

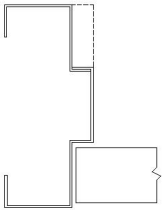

Jamb or Head

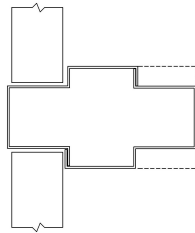

Welded or Removable  
Mullion Between Doors

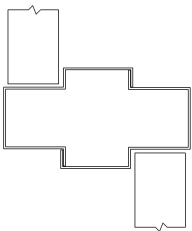

Welded or Removable  
Contra-Swing Mullion

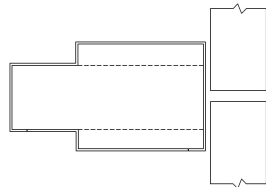

Welded or Removable  
Mullion Behind Doors

## PRODUCT

3 Hour (maximum) fire door frames, used with fire doors swinging singly or in pairs.

## MAXIMUM DOOR OPENING

Singles: 4'0" x 10'0" (1219 x 3048 mm)

Pairs: 8'0" x 10'0" (2438 x 3048 mm)

Contra-Swing: 4'0" x 8'0" (1219 x 2438 mm)

(NOTE: Contra-Swing frames limited to 1-1/2 Hour fire protection rating.)

## MAXIMUM LEAF SIZE

Singles and Pairs: 4'0" x 10'0" (1219 x 3048 mm)

Contra-Swing: 4'0" x 8'0" (1219 x 2438 mm)

## MULLIONS

Mullions are optional and may be welded or removable, for either between or behind the door applications. Doors shall not be hinged off removable mullions.

## ANCHORS

Anchors are available for new or existing masonry, poured concrete, structural steel, wood and steel stud partitions.

## SPECIFICATIONS

Frames shall be fabricated from hot rolled, cold rolled, galvanized, galvanized or stainless steel. Refer to "Profiles for Fire Rated Frame Products."

## PROFILES

Single or double rabbet jambs, heads and mullions.



150 Division Drive  
Wilmington, NC 28401  
[www.CustomMetalProductsNC.com](http://www.CustomMetalProductsNC.com)

Revised 041907

Phone: 866-893-3338  
Fax: 866-963-1355  
[Info@CustomMetalProducts.bz](mailto:Info@CustomMetalProducts.bz)